



Northmead, NSW

20/18-24 Murray Street

2
BED

2
BATH

2
CAR

 **Guardian**
Property Specialists

Here is the best of what you will find anywhere locally, an Extra Large two bedroom Plus Study Apartment with two bathrooms, large semi enclosed balcony, double basement car spaces and a storage room.

This Extra Large apartment has been renovated with new laminate floor boards, a fresh coat of paint and a detailed clean.

Internal size plus balcony: 110 sqm

Total size: 167 sqm

With a decent district view of tree tops in a quite street, it makes a great place to live or invest with all the right features.

\$639,000

Council Rates: \$270/qtr (approx)

Water Rates: \$180/qtr (approx)

Strata Fees: \$870/qtr (approx)

Contact: Roy Halabi
0414 622 422
Ahmed Osmany
0433 983 532

Type: Apartment

Sold Date: 06/06/2020

Land: 167 Square Metres

<https://www.gps.properties>

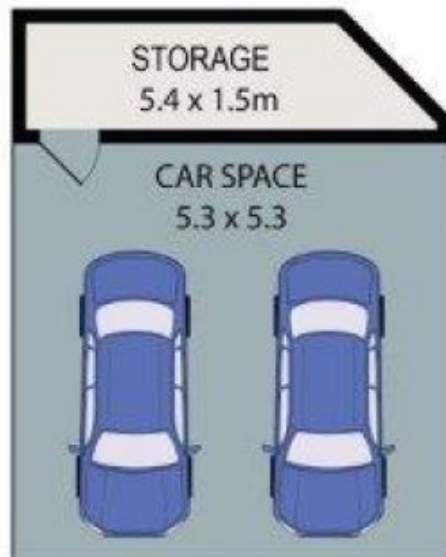
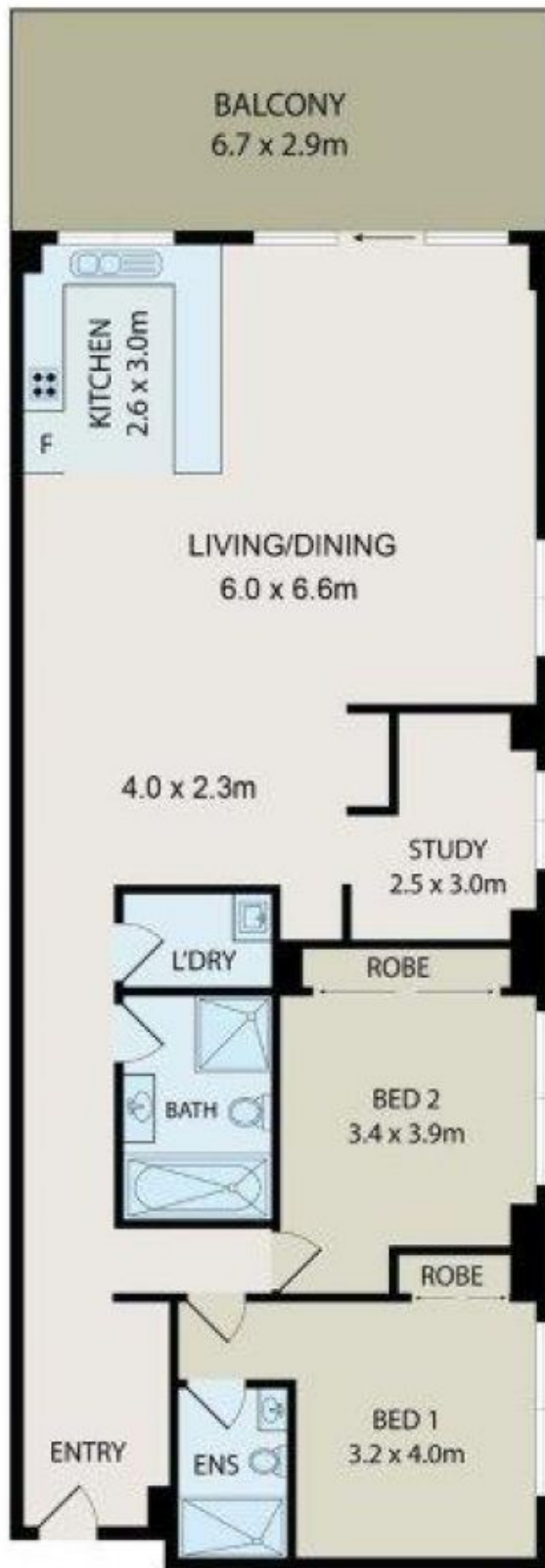

Plans shown are only indicative of layout. Dimensions are approximate.



0
1
2
3
4
5
All
relie
rely

Northmead, NSW
20/18-24 Murray Street

20/18-24 Murray Street, Northmead